

SPARE PARTS BREAKDOWN:

Backwash 3-way hydraulic valve - 2"

Description	Cat. No.
3-way hydraulic valve, 2"	71600-006515

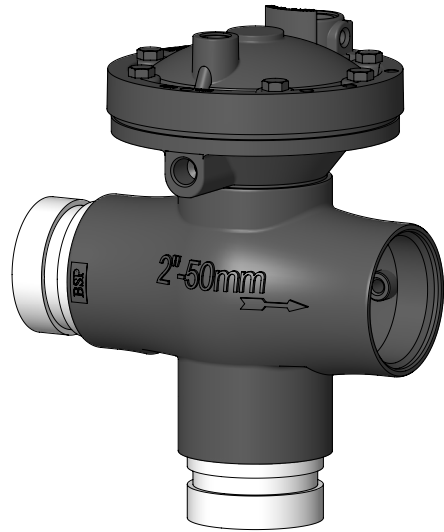

Main parts

Part	Description	Cat. No.
1	Operator assembly	71680-006595
2	Body BSP	71680-001715
3	Plug	71610-000800
4	Grooved adaptor BSP	71680-015710
5	O-ring	71680-014350
6	Elbow 8 x 1/4 in	76400-003500

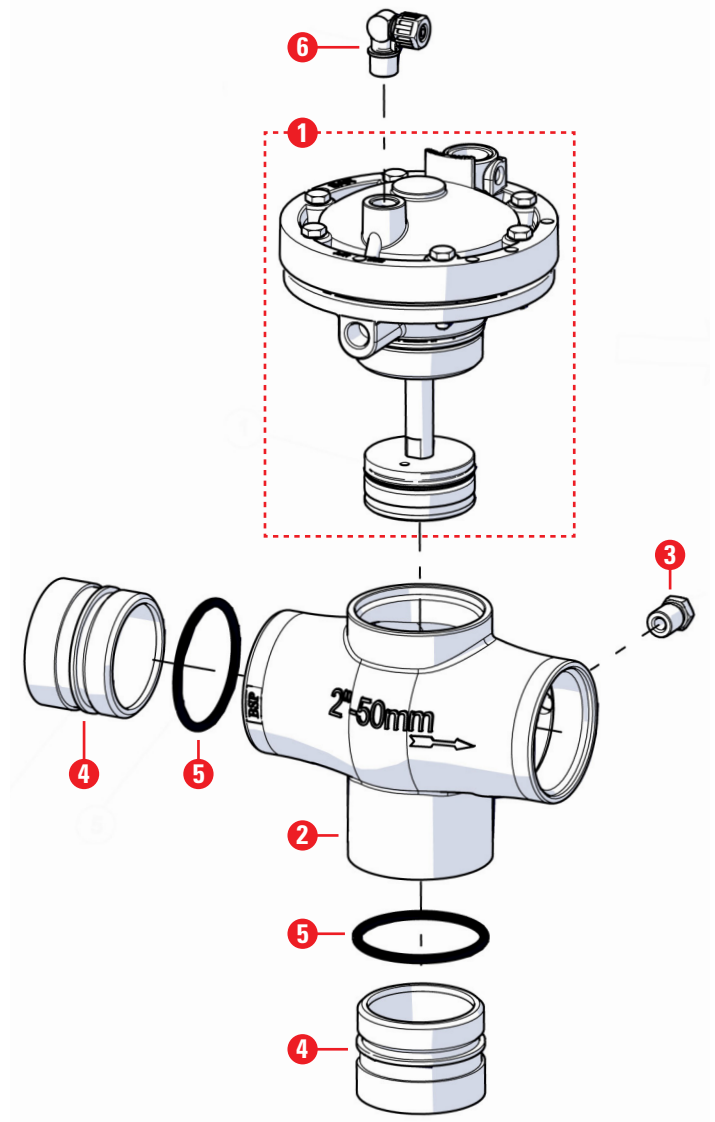

Assemblies

Part	Description	Cat. No.
1	Operator assembly	71680-006595
1a	Diaphragm assembly	71680-007480
1b	Plug kit	71680-001720

Assemblies - sub-parts

part	Description	1	1a	1b
1.1	Bolt	+		
1.2	Bonnet	+		
1.3	Spring No. 51	+		
1.4	Bolt	+	+	
1.5	Diaphragm disc	+	+	
1.6	Diaphragm No. 337	+	+	
1.7	Actuator body	+		
1.8	O-ring	+	+	
1.9	O-ring	+	+	
1.10	Shaft	+	+	
1.11	Valve disc	+		+
1.12	Seal	+		+
1.13	Seal disc	+		+
1.14	Nut	+		+
1.15	Washer	+		
1.16	Nut M6	+		

